

AC 应用

外 壳： 塑料外壳封装
工作温度： -40 °C 至 +85 °C (Ths≤85°C)
容量范围： 0.1 至 16μF (±5%, ±10%)
额定电压： 250 至 500 VAC
安全认证： UL810 结构认证 E346002

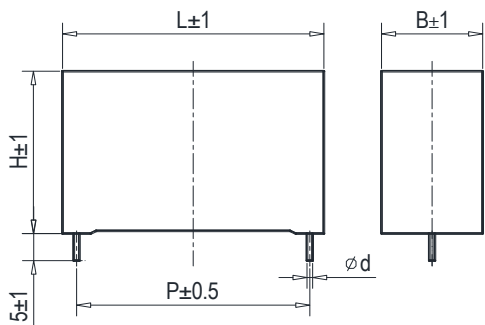

特性参数

订货代码	容量 (μF)	尺寸 (mm)					Du/dt (v/μs)
		L	B	H	P	d	
Urms 250VAC/50-60Hz, Upeak 353V							
STR-250-0.33-22.5	0.33	26.5	7.0	16.0	22.5	0.8	56
STR-250-0.39-22.5	0.39	26.5	7.0	16.0	22.5	0.8	56
STR-250-0.47-22.5	0.47	26.5	7.0	16.0	22.5	0.8	56
STR-250-0.56-22.5	0.56	26.5	8.5	17.0	22.5	0.8	56
STR-250-0.68-22.5	0.68	26.5	8.5	17.0	22.5	0.8	56
STR-250-0.68-27.5	0.68	31.0	9.0	18.0	27.5	0.8	45
STR-250-0.82-22.5	0.82	26.5	10.0	18.5	22.5	0.8	56
STR-250-0.82-27.5	0.82	31.0	9.0	18.0	27.5	0.8	45
STR-250-1.0-22.5	1.0	26.5	10.0	18.5	22.5	0.8	56
STR-250-1.0-27.5	1.0	31.0	9.0	18.0	27.5	0.8	45
STR-250-1.2-22.5	1.2	26.5	11.0	20.0	22.5	0.8	56
STR-250-1.2-27.5	1.2	31.0	9.0	18.0	27.5	0.8	45
STR-250-1.5-22.5	1.5	26.5	12.0	22.0	22.5	0.8	56
STR-250-1.5-27.5	1.5	31.0	11.0	20.0	27.5	0.8	45
STR-250-1.8-27.5	1.8	31.0	11.0	20.0	27.5	0.8	45
STR-250-2.0-27.5	2.0	31.0	13.0	22.0	27.5	0.8	45
STR-250-2.2-27.5	2.2	31.0	13.0	22.0	27.5	0.8	45
STR-250-2.5-27.5	2.5	31.0	15.0	24.5	27.5	0.8	45
STR-250-3.0-27.5	3.0	31.0	15.0	24.5	27.5	0.8	45
STR-250-3.3-27.5	3.3	31.0	15.0	24.5	27.5	0.8	45
STR-250-3.5-27.5	3.5	31.0	17.0	28.0	27.5	0.8	45
STR-250-4.0-27.5	4.0	31.0	17.0	28.0	27.5	0.8	45
STR-250-4.5-27.5	4.5	31.0	17.0	28.0	27.5	0.8	45
STR-250-4.7-27.5	4.7	31.0	18.0	33.0	27.5	0.8	45
STR-250-4.7-37.5	4.7	42.5	15.0	26.0	37.5	1.0	30
STR-250-5.0-27.5	5.0	31.0	18.0	33.0	27.5	0.8	45
STR-250-5.0-37.5	5.0	42.5	15.0	26.0	37.5	1.0	30
STR-250-6.0-37.5	6.0	42.5	17.0	28.0	37.5	1.0	30
STR-250-6.5-37.5	6.5	42.5	17.0	28.0	37.5	1.0	30
STR-250-8.0-37.5	8.0	42.5	22.0	30.0	37.5	1.0	30

特性参数

订货代码	容量 (μF)	尺寸 (mm)					Du/dt ($\text{V}/\mu\text{s}$)
		L	B	H	P	d	
Urms 250VAC/50-60Hz , Upeak 353V							
STR-250-10-37.5	10	42.5	22.0	30.0	37.5	1.0	30
STR-250-12-37.5	12	42.5	28.0	37.0	37.5	1.0	30
STR-250-15-37.5	15	42.5	28.0	37.0	37.5	1.0	30
STR-250-18-37.5	18	42.5	33.0	45.0	37.5	1.0	30
STR-250-20-37.5	20	42.5	33.0	45.0	37.5	1.0	30
STR-250-25-52.5	25	57.5	30.0	45.0	52.5	1.2	20
STR-250-30-52.5	30	57.5	30.0	45.0	52.5	1.2	20
STR-250-35-52.5	35	57.5	35.0	50.0	52.5	1.2	20
STR-250-40-52.5	40	57.5	35.0	50.0	52.5	1.2	20
Urms 320VAC/50-60Hz , Upeak 452V							
STR-320-0.33-22.5	0.33	26.5	7.0	16.0	22.5	0.8	73
STR-320-0.39-22.5	0.39	26.5	7.0	16.0	22.5	0.8	73
STR-320-0.47-22.5	0.47	26.5	8.5	17.0	22.5	0.8	73
STR-320-0.56-22.5	0.56	26.5	8.5	17.0	22.5	0.8	73
STR-320-0.68-22.5	0.68	26.5	10.0	18.5	22.5	0.8	73
STR-320-0.68-27.5	0.68	31.0	9.0	18.0	27.5	0.8	59
STR-320-0.82-22.5	0.82	26.5	11.0	20.0	22.5	0.8	73
STR-320-0.82-27.5	0.82	31.0	9.0	18.0	27.5	0.8	59
STR-320-1.0-22.5	1.0	26.5	12.0	22.0	22.5	0.8	73
STR-320-1.0-27.5	1.0	31.0	11.0	20.0	27.5	0.8	59
STR-320-1.2-27.5	1.2	31.0	11.0	20.0	27.5	0.8	59
STR-320-1.5-27.5	1.5	31.0	13.0	22.0	27.5	0.8	59
STR-320-1.8-27.5	1.8	31.0	15.0	24.5	27.5	0.8	59
STR-320-2.0-27.5	2.0	31.0	15.0	24.5	27.5	0.8	59
STR-320-2.2-27.5	2.2	31.0	15.0	24.5	27.5	0.8	59
STR-320-2.5-27.5	2.5	31.0	17.0	28.0	27.5	0.8	59
STR-320-2.7-27.5	2.7	31.0	17.0	28.0	27.5	0.8	59
STR-320-3.0-27.5	3.0	31.0	17.0	28.0	27.5	0.8	59
STR-320-3.0-37.5	3.0	42.5	15.0	26.0	37.5	1.0	39
STR-320-3.3-27.5	3.3	31.0	18.0	33.0	27.5	0.8	59
STR-320-3.3-37.5	3.3	42.5	15.0	26.0	37.5	1.0	39
STR-320-3.5-27.5	3.5	31.0	18.0	33.0	27.5	0.8	59
STR-320-3.5-37.5	3.5	42.5	15.0	26.0	37.5	1.0	39
STR-320-4.0-37.5	4.0	42.5	17.0	28.0	37.5	1.0	39
STR-320-4.5-37.5	4.5	42.5	17.0	28.0	37.5	1.0	39
STR-320-4.7-37.5	4.7	42.5	17.0	28.0	37.5	1.0	39
STR-320-5.0-37.5	5.0	42.5	22.0	30.0	37.5	1.0	39
STR-320-6.0-37.5	6.0	42.5	22.0	30.0	37.5	1.0	39
STR-320-6.8-37.5	6.8	42.5	22.0	30.0	37.5	1.0	39
STR-320-8.0-37.5	8.0	42.5	28.0	37.0	37.5	1.0	39
STR-320-10-37.5	10	42.5	28.0	37.0	37.5	1.0	39
STR-320-11-37.5	11	42.5	28.0	37.0	37.5	1.0	39
STR-320-12-37.5	12	42.5	33.0	45.0	37.5	1.0	39
STR-320-13-37.5	13	42.5	33.0	45.0	37.5	1.0	39
STR-320-14-37.5	14	42.5	33.0	45.0	37.5	1.0	39
STR-320-15-37.5	15	42.5	33.0	45.0	37.5	1.0	39
STR-320-18-52.5	18	57.5	30.0	45.0	52.5	1.2	26
STR-320-20-52.5	20	57.5	30.0	45.0	52.5	1.2	26
STR-320-22-52.5	22	57.5	30.0	45.0	52.5	1.2	26
STR-320-25-52.5	25	57.5	35.0	50.0	52.5	1.2	26
STR-320-28-52.5	28	57.5	35.0	50.0	52.5	1.2	26

特性参数

订货代码	容量 (μF)	尺寸 (mm)					Du/dt ($\text{V}/\mu\text{s}$)
		L	B	H	P	d	
Urms 400VAC/50-60Hz , Un 570VAC							
STR-400-2.2-37.5	2.2	42.5	17.0	28.0	37.5	1.0	60
STR-400-2.5-37.5	2.5	42.5	17.0	28.0	37.5	1.0	60
STR-400-3.0-37.5	3.0	42.5	22.0	30.0	37.5	1.0	60
STR-400-3.3-37.5	3.3	42.5	22.0	30.0	37.5	1.0	60
STR-400-3.5-37.5	3.5	42.5	22.0	30.0	37.5	1.0	60
STR-400-5.5-37.5	5.5	42.5	28.0	37.0	37.5	1.0	60
STR-400-6.0-37.5	6.0	42.5	28.0	37.0	37.5	1.0	60
STR-400-6.3-37.5	6.3	42.5	28.0	37.0	37.5	1.0	60
STR-400-6.8-37.5	6.8	42.5	33.0	45.0	37.5	1.0	60
STR-400-7.0-37.5	7.0	42.5	33.0	45.0	37.5	1.0	60
STR-400-8.0-37.5	8.0	42.5	33.0	45.0	37.5	1.0	60
STR-400-8.5-37.5	8.5	42.5	33.0	45.0	37.5	1.0	60
STR-400-10-52.5	10	57.5	30.0	45.0	52.5	1.2	40
STR-400-12-52.5	12	57.5	30.0	45.0	52.5	1.2	40
STR-400-15-52.5	15	57.5	35.0	50.0	52.5	1.2	40
STR-400-16-52.5	16	57.5	35.0	50.0	52.5	1.2	40
Urms 500VAC/50-60Hz , Un 710VAC							
STR-500-0.10-22.5	0.10	26.5	8.5	17.0	22.5	0.8	208
STR-500-0.15-22.5	0.15	26.5	10.0	18.5	22.5	0.8	208
STR-500-0.18-22.5	0.18	26.5	10.0	18.5	22.5	0.8	208
STR-500-0.18-27.5	0.18	31.0	9.0	18.0	27.5	0.8	166
STR-500-0.22-22.5	0.22	26.5	11.0	20.0	22.5	0.8	208
STR-500-0.22-27.5	0.22	31.0	11.0	20.0	27.5	0.8	166
STR-500-0.27-22.5	0.27	26.5	12.0	22.0	22.5	0.8	208
STR-500-0.27-27.5	0.27	31.0	11.0	20.0	27.5	0.8	166
STR-500-0.33-27.5	0.33	31.0	13.0	22.0	27.5	0.8	166
STR-500-0.39-27.5	0.39	31.0	13.0	22.0	27.5	0.8	166
STR-500-0.47-27.5	0.47	31.0	15.0	24.5	27.5	0.8	166
STR-500-0.56-27.5	0.56	31.0	15.0	24.5	27.5	0.8	166
STR-500-0.68-27.5	0.68	31.0	17.0	28.0	27.5	0.8	166
STR-500-0.68-37.5	0.68	42.5	15.0	26.0	37.5	1.0	111
STR-500-0.75-27.5	0.75	31.0	17.0	28.0	27.5	0.8	166
STR-500-0.75-37.5	0.75	42.5	15.0	26.0	37.5	1.0	111
STR-500-0.82-27.5	0.82	31.0	18.0	33.0	27.5	0.8	166
STR-500-0.82-37.5	0.82	42.5	15.0	26.0	37.5	1.0	111
STR-500-1.0-27.5	1.0	31.0	18.0	33.0	27.5	0.8	166
STR-500-1.0-37.5	1.0	42.5	17.0	28.0	37.5	1.0	111
STR-500-1.2-37.5	1.2	42.5	22.0	30.0	37.5	1.0	111
STR-500-1.5-37.5	1.5	42.5	22.0	30.0	37.5	1.0	111
STR-500-1.8-37.5	1.8	42.5	28.0	37.0	37.5	1.0	111
STR-500-2.0-37.5	2.0	42.5	28.0	37.0	37.5	1.0	111
STR-500-2.2-37.5	2.2	42.5	28.0	37.0	37.5	1.0	111
STR-500-2.5-37.5	2.5	42.5	28.0	37.0	37.5	1.0	111
STR-500-2.7-37.5	2.7	42.5	28.0	37.0	37.5	1.0	111
STR-500-3.0-37.5	3.0	42.5	33.0	45.0	37.5	1.0	111
STR-500-3.3-37.5	3.3	42.5	33.0	45.0	37.5	1.0	111
STR-500-4.0-52.5	4.0	57.5	30.0	45.0	52.5	1.2	74
STR-500-4.5-52.5	4.5	57.5	30.0	45.0	52.5	1.2	74
STR-500-5.0-52.5	5.0	57.5	30.0	45.0	52.5	1.2	74
STR-500-6.0-52.5	6.0	57.5	35.0	50.0	52.5	1.2	74
STR-500-7.0-52.5	7.0	57.5	35.0	50.0	52.5	1.2	74